

- Front square and round application to panel or mimic diagram.
- Front dimension 35x35mm. or Ø33mm.
- DIN43700, DIN43802, DIN43718, IEC1010, IEC473, IEC51, BS89
- Polycarbonate, self extinguishing and drip-proof per UL94V-0
- Rugged housing-non combustible, plastic-heat resistance.

**Characteristic**

Display  
Graduation : Large LED, red and green  
Pointer : Bar Beam comply with DIN 43802, parts 2

Indication  
Color display : X0-X1 Green lamp  
: X0-X2 Red lamp

Mechanical Design  
Housing Material : Polycarbonate, self-extinguishing and drip-proof per UL94V-0  
Mounting : Front tightening  
Terminals : Screw terminals self-lifting terminal clips. Screws can be turned with standard screw drivers tool.  
Contact Protection : Finger-safe full cover included  
Dimension : 35x35x57mm. for Square type.  
: Ø33x57mm. for Round type.  
Diameter Cutout : 22mm.

Electrical  
Burden : 1.6VA  
Response Time : 0.5 Sec  
Insulation : ≤ 100M  
Withstanding Voltage : 2.5KV. AC/DC

Ambient Conditions  
Operating Temperature : - 20 ... + 65 °C  
Storage Temperature : - 40 ... + 75 °C  
Relative Humidity : max. 95%

Compliance with Regulations  
Protection : IP 52 front panel, Terminal IP20  
Protection : Class 1

**Application**

Position Indicator or Simulation Working State Indicator, indicate the position and status of all kind of switch equipments such as circuit-breaker, C.B., truck and earthing switch. It can be applied widely in many kinds of central control room to simulating the screen and plate of switch cabinet in power plant, power station, transformer substation, main distribution board & etc. to show working status of system & direct acting the indication of electrical measuring system. They are suitable to used on the distribution panel, control panel, control room, switch board panel, power plant, diagram board, mimic board, machine control and the different apparatus and etc.

The instruments has designed for industrial applications which required precise, reliable and robust instruments for the display range and indicating. Each measuring instrument is suited for one of the following measuring tasks:

- AC Volt 36, 48, 65, 110, 120, 230 V or request.
- DC Volt 24, 48, 60, 110, 125, 220 V or request.
- Disconnecting switch indicator Model PD11(round)  
Model PD12(Square)
- Circuit breaker switch indicator Model PC11(round)  
Model PC12(Square)
- Earthing switch indicator Model PE11(round)  
Model PE12(Square)

**Wiring Diagram**

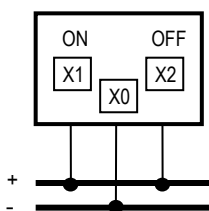

**Dimension**

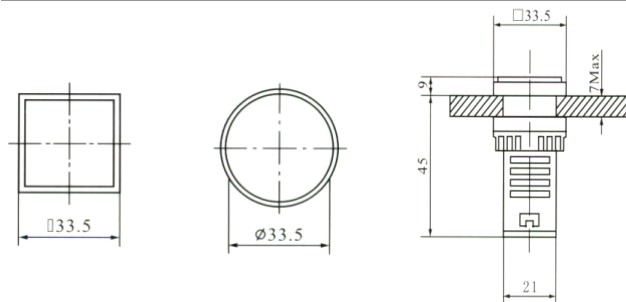

**Indication**

Display		
Circuit Breaker or Earthing Switch or ETC.	" OFF "	" ON "